



NO.1100

- * Using No. 10 Staples.
- * Ergonomic Shape for comfort



BOX OF 12 PCS



BOX OF 1 PC

>>1100-SDI

- 1 PC / BOX
- 12 PCS / MED BOX
- 240 PCS / CARTON

CTN M ³	L x W x H (mm)
	420 x 335 x 230
1100-SDI (1 PC)	1100-SDI (12 PCS)
4 711734 110007	4 711734 910003

RSP INCL G.S.T.



40-SHEET REDUCED EFFORT STAPLER



Flat-Clinch

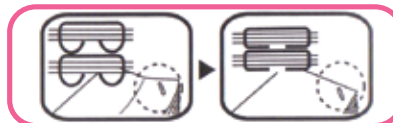

Saves up to 30% space



BOX OF 1 PC

>>1173B-SDI

- 1 PC / BOX
- 12 PCS / MED BOX
- 24 PCS / CARTON

CTN M ³	L x W x H (mm)
	385 x 340 x 215
1173B-SDI (1 PC)	
4 711734 117303	

RSP INCL G.S.T.